

## Adding the Equilume Stable Light App to your device.

### Stable Light App Version

App: v0.7



Apple:

The Stable Light App is compatible with:

**Apple: iOS 13 and newer** (Released in September 2019, iPhone 6s and newer)

### How to check which version of iOS is on your phone:

1. **Open the Settings app:** Look for the gear icon on your home screen and tap it.
2. Go to **General:** Scroll down and tap on the "General" option.
3. Tap **About:** At the top of the General page, you'll see the "About" option. Tap on it.
4. Find the **iOS Version:** On the About page, you'll see various details about your device. Look for the "Software Version" entry, which will display the current version of iOS installed on your device.

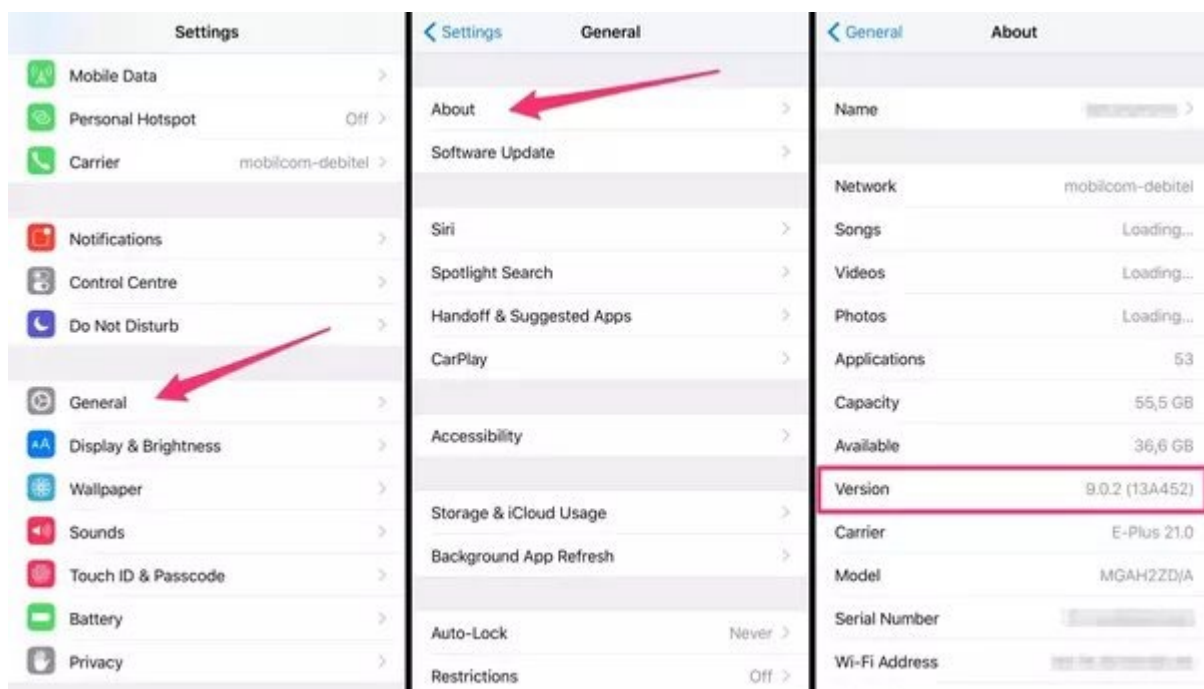

## How to update iOS on your phone:

1. **Connect to Wi-Fi:** Ensure your device is connected to a Wi-Fi network.
2. **Plug in your device:** Make sure your device is plugged into a power source to avoid running out of battery during the update process.
3. Open the **Settings** app: Tap on the gear icon on your home screen to open the Settings app.
4. Go to **General:** Scroll down and tap on the "General" option.
5. **Tap Software Update:** This will check for available updates. If an update is available, it will be displayed here.
6. **Download and Install:** Tap on "Download and Install." You may be asked to enter your passcode.
7. **Agree to the Terms and Conditions:** Read and agree to Apple's terms and conditions to proceed.
8. **Wait for the Update to Download:** The update will start downloading. Once the download is complete, your device will prompt you to install the update.
9. Install the Update: Tap on "Install Now." Your device will restart and the update process will begin. This can take several minutes.
10. **Finish Setup:** Once the update is complete, your device will restart again. You may be asked to enter your passcode and follow a few on-screen instructions to complete the setup.

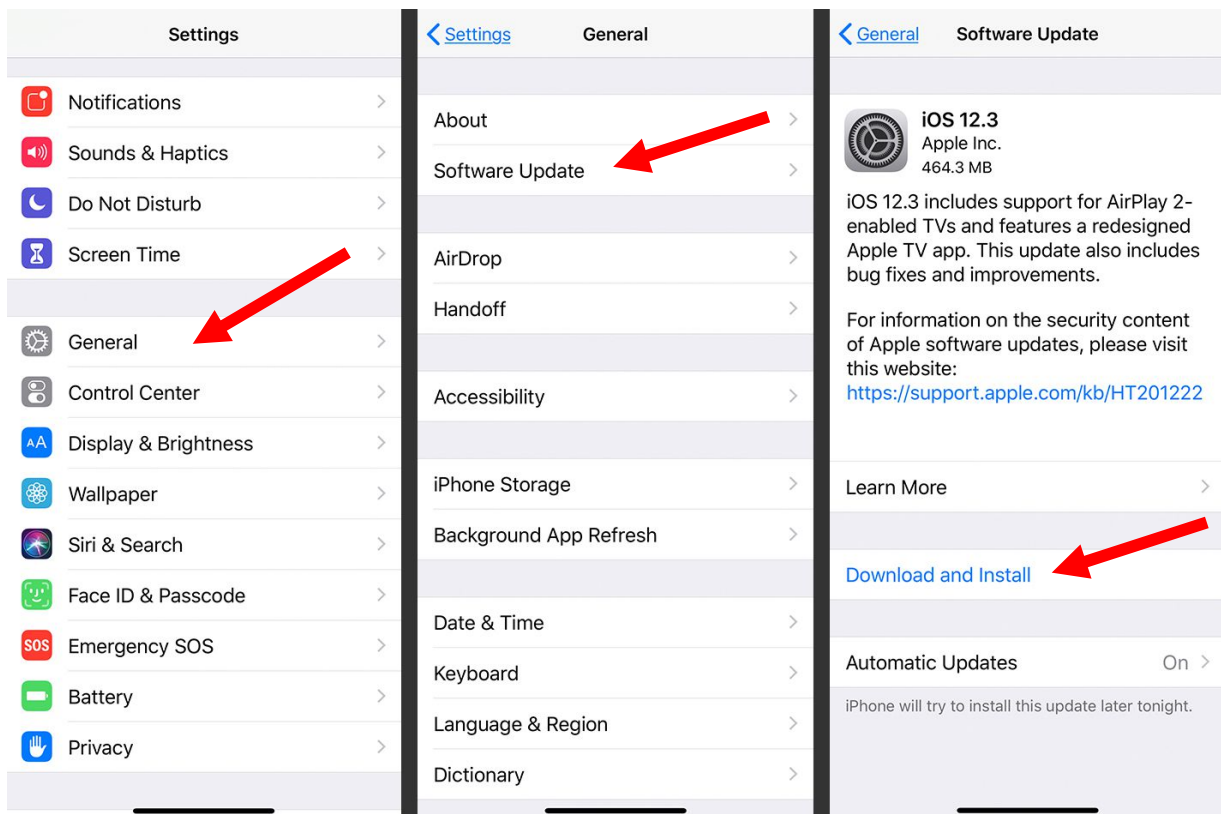

## How to purchase and download the Equilume Stable Light app to your device:

1. **Open the App Store:** Look for the blue App Store icon on your home screen and tap it.
2. **Search for the App:**
  - Tap the "Search" tab at the bottom right corner of the screen.
  - In the search bar at the top, type "Equilume Stable Light" and tap "Search" on your keyboard.
3. **Find the App:** Browse through the search results until you find "Equilume Stable Light." Make sure it's the correct app by checking the developer's name and app description if needed.
4. **Purchase the App:**
  - Tap the app icon or name to go to the app's detail page.
  - Tap the price button, which will display the cost of the app. This button may show "Buy" followed by the price.
  - Authenticate your purchase. You might be prompted to enter your Apple ID password, use Touch ID, or Face ID to confirm the purchase.
5. **Wait for the Download to Complete:** After purchasing, the app will start downloading. Once it's done, the button will change to "Open."
6. **Open the App:** Tap "Open" to launch the app immediately, or return to your home screen where you'll find the app icon to open it later.

## Ensure Payment Method is Set Up

If you haven't set up a payment method yet, you'll need to do so before purchasing apps:

1. **Open the Settings app:** Tap the gear icon on your home screen.
2. **Tap your name at the top:** This will take you to your Apple ID settings.
3. **Tap Payment & Shipping:** You may need to enter your Apple ID password.
4. **Add Payment Method:** Tap "Add Payment Method" and enter your payment details. Follow the prompts to save your payment information.

By following these steps, you can successfully purchase and download "Equilume Stable Light" on your iPhone.

## Bluetooth

Bluetooth is required to connect the Stable Lights to the Stable Light App on your phone.

How to check if Bluetooth is turned on/off your Apple device:

1. Open the **Settings** app.
2. Tap on **Bluetooth**.
3. Check the toggle switch at the top:
  - If the switch is green, Bluetooth is ON.
  - If the switch is gray, Bluetooth is OFF.

## App Software Update

How to find the version of software in the App to check if it needs to be updated

1. Open the Equilume Stable Light **App**
2. Go to **Settings** (top left corner icon)
3. Put in **Pin**
4. Select **About**

## How to update the Stable Light App on your Apple device:

1. Open the **App Store**: Tap on the "App Store" icon on your home screen. It usually resembles a blue icon with a white "A" on it.
2. Navigate to the **Updates Tab**.
  - At the bottom of the screen, you'll see several options like "Today," "Games," "Apps," and "Updates."
  - Tap on the "Updates" tab.
3. Check for **Available Updates**
  - The Updates tab will display a list of apps that have available updates. If there are updates available, you'll see them listed here.
4. Update All or Individual Apps.
  - You have the option to update individual apps by tapping the **"Update"** button next to each app, or you can update all apps at once by tapping "Update All" at the top of the list.
5. Enter Your Apple ID Password.
  - If prompted, **enter your Apple ID password** or use Touch ID/Face ID to authenticate the update process.
6. Wait for Updates to **Download and Install**.
  - Depending on the size of the updates and your internet connection speed, the updates may take a few seconds or longer to download and install.
7. Check App Version.
  - Once the updates are installed, you can **check the app version** by going back to the Updates tab and ensuring that all apps are up-to-date.



## Android:

The Stable Light App is compatible with:

**Android version 8 and newer** (This covers an estimated 95% of all Android-based phones.)  
App is incompatible with Android Go, a stripped-down version of Android.

### How to check which version of Android is on your phone:

1. Open the **Settings** app: Look for the gear icon on your home screen or app drawer and tap it.
2. Scroll down and tap **About phone**: This option is typically found towards the bottom of the Settings menu. On some devices, it may be labeled as "About device" or simply "About."
3. Find the **Android version**: Look for a section labeled "Android version." The specific version of Android installed on your device will be listed there. On some devices, you may need to tap on "Software information" or similar to see the Android version details.

**NOTE:** This process may vary slightly depending on the manufacturer and model of your device, but the general steps should be similar across most Android smartphones.

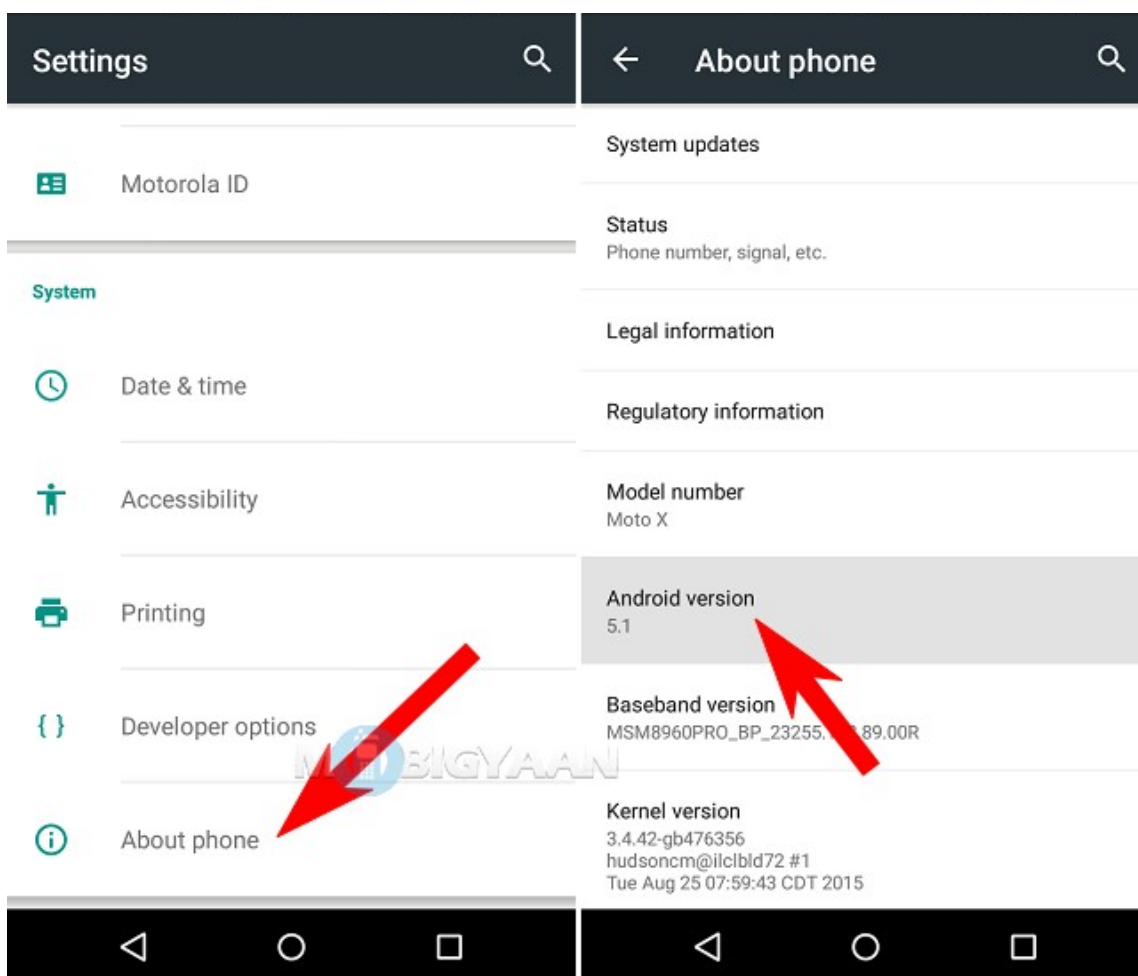

## How to update to the newest version of Android on your phone:

1. **Connect to Wi-Fi:** Ensure your device is connected to a Wi-Fi network to avoid using mobile data for the update.
  2. Open the **Settings** app: Tap on the gear icon on your home screen or in the app drawer.
  3. Scroll down and tap **System**: This option is typically found towards the bottom of the Settings menu. On some devices, it may be labeled as "Software Update" or similar.
  4. **Tap Advanced** (if applicable): Some devices require you to tap "Advanced" to see more options.
  5. Tap **System Update or Software Update**: This will check for available updates. If an update is available, it will be displayed here.
  6. **Download and Install**: If an update is available, tap "Download" or "Download and Install." Follow the on-screen instructions. You may need to agree to the terms and conditions.
  7. **Restart and Install**: Once the download is complete, tap "Install." Your device will restart and the installation process will begin. This can take several minutes.
  8. **Finish Setup**: Once the update is complete, your device will restart again. Follow any on-screen instructions to complete the setup.
- **Notes:**
    - **Battery:** Ensure your device has sufficient battery life before starting the update process. It's best to have your device charged to at least 50%.
    - **Backup:** Consider backing up your data before performing the update to avoid any potential data loss.
    - **Compatibility:** Not all devices will receive the latest Android updates immediately. Availability depends on the device manufacturer, model, and carrier.

## How to purchase and download the Equilume Stable Light app to your device:

1. **Open the Google Play Store:** Look for the Play Store icon on your home screen or in your app drawer and tap it.
2. **Search for the App:**
  - Tap the search bar at the top of the screen.
  - Type "Equilume Stable Light" and tap the search icon on your keyboard.
3. **Find the App:** Browse through the search results until you find "Equilume Stable Light." Make sure it's the correct app by checking the developer's name and app description if needed.
4. **Purchase the App:**
  - Tap the app icon or name to go to the app's detail page.
  - Tap the price button, which will display the cost of the app. This button may show "Buy" followed by the price.
  - You might be prompted to choose a payment method if you haven't already set one up.
5. **Confirm Your Purchase:**
  - Follow the on-screen instructions to confirm your purchase. You may need to enter your Google account password or use biometric authentication (fingerprint or face recognition).
6. **Wait for the Download to Complete:** After purchasing, the app will start downloading. Once it's done, the button will change to "Open."
7. **Open the App:** Tap "Open" to launch the app immediately, or return to your home screen where you'll find the app icon to open it later.

## Ensure Payment Method is Set Up

If you haven't set up a payment method yet, you'll need to do so before purchasing apps:

1. **Open the Google Play Store:** Tap the Play Store icon.
2. **Open the Menu:** Tap the three horizontal lines or your profile icon in the top left corner.
3. **Go to Payment Methods:** Tap "Payments & subscriptions" and then "Payment methods."
4. **Add Payment Method:** Follow the instructions to add a credit/debit card, PayPal, or other payment options.

By following these steps, you can successfully purchase and download "Equilume Stable Light" on your Android smartphone.

## Bluetooth

Bluetooth is required to connect the Stable Lights to the Stable Light App on your phone.

How to check if Bluetooth is turned on/off your Android device:

1. Open the **Settings** app.
2. Tap on **Connected Devices** or **Connections**.
3. Tap on **Bluetooth**.
4. Check the toggle switch:
  - If the switch is blue, Bluetooth is ON.
  - If the switch is gray, Bluetooth is OFF.

## How to update the Stable Light App on your Android device:

1. Open **Google Play Store**.
  - Tap on the "Play Store" icon on your home screen. It typically looks like a multicoloured triangle.
2. Access the Menu.
  - Tap on the **three horizontal lines** (hamburger icon) at the top-left corner of the screen to open the menu.
3. Go to "My apps & games."
  - In the menu, select **"My apps & games."** This will take you to a list of all the apps installed on your device.
4. Check for Updates.
  - Here, you'll see a list of apps with available updates. If updates are available, you'll see an **"Update"** button next to each app.
5. Update All or Individual Apps.
  - You can update all apps at once by tapping **"Update all"** at the top of the list, or you can update individual apps by tapping the "Update" button next to each app.
6. Wait for Updates to **Download and Install**.
  - Similar to iOS, the updates will start downloading and installing automatically. Depending on the size of the updates and your internet connection speed, this process may take some time.
7. **Check App Version.**
  - After the updates are installed, you can verify that all apps are up-to-date by going back to "My apps & games" and ensuring that there are no pending updates.

By following these steps, you can easily check for app updates and ensure that your iOS or Android device is running the latest versions of all installed apps.